



## FEATURES

### TOGGLE MODULATION ON AND OFF

The modulation of the headlight can be toggled on and off by the user during daytime hours, as per DOT regulations this feature does is not available at night. When the bike is started the default is modulation ON. To turn the modulation on or off simply switch your bikes high low beam switch to the opposite position, and then back to the original position within one second (this can be done with the switch in either the high or low beam position).

### FULL FUNCTION

You do not have to compromise between the high beam and low beam with a Signal Dynamics Plug & Play™ Headlight Module because this module will modulate your high OR low beam headlight(s)... you get to choose whenever you want! This feature is useful along with the ON/OFF feature: i.e. You're riding in heavy traffic and you don't want to annoy the bumper to bumper traffic ahead of you, so you switch your modulating low beam(s) off and turn on your solid non-modulating high beam(s).

### AUTO NIGHT SHUT-OFF

The Plug & Play™ Headlight Module is designed to automatically turn on and off at specific light levels in order to comply with the DOT's regulation of no night time modulation.

### SWITCH FROM MAX TO MIN MODE

This module is equipped with two levels of modulation to meet your visibility requirements. (Both are fully DOT compliant). The default level is "Max" when the bike is turned on, but can easily be toggled to "Min" or back to "Max" by simply pressing the horn button twice within one second.

### HEADS UP ALERT FEATURE

The Headlight Module harness has a green wire that can be connected to your horn wire in order to add a visual alert to your horn's audible alert. Pressing the horn will cause your headlight to modulate for 3 seconds (if the module is off) and then return to steady on; If your headlight is already modulating it will instead toggle between min and max mode for 3 seconds, thus giving you a faster flash rate for 3 seconds to give that approaching vehicle a 'heads up'.

### EMERGENCY HEADLIGHT FEATURE

The Headlight Module is constantly monitoring the bulb that you have selected (high beam or low beam). In the event the bulb(s) should fail; the alternate bulb(s) will instantly be turned on. This switching will only be done once; when the bike is turned off and then back on. Additionally you will not have use of the bulb that failed until it is repaired or replaced. While the Heads-Up™ Alert feature will continue to function in the event of a headlight failure, the headlight will not modulate otherwise. If you find you cannot get your headlight to modulate, check the bulb.

### NO EXCESSIVE HEAT BUILD-UP

Handles high power demand sealed beam and halogen headlights totaling up to 130 watts! Operates efficiently with only slight increase above ambient temperature at continuous max headlight power rating.

### SURGE PROTECTED

Internal protection against transient voltage spikes during engine starts or charging system operation. Also drops out if voltage is too low, avoiding problems associated with low voltage.

# PLUG & PLAY

## HEADLIGHT MODULE + DUAL H7 JAPANESE HARNESS

## INSTALLATION INSTRUCTIONS

### WARNING:

Polarity is important during installation. Be sure the ground wires on your motorcycle match with the **BLACK GROUND** wire on our harness adapter.  
(You will blow a fuse if incorrect)

### PN 01182 (COMBO PACK)

#### INCLUDES:

PN 01015 (Headlight Module)  
PN 01082 (Dual H7 Harness)

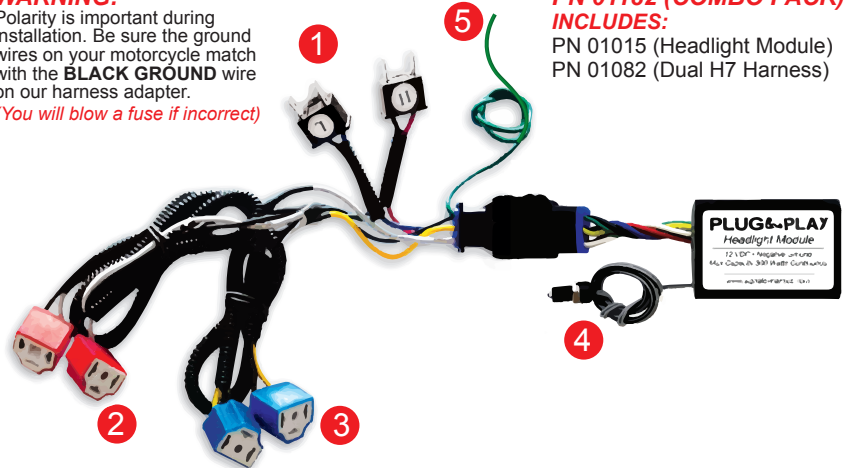

1. Connect to your **LEFT** headlights HIGH and LOW plugs, secure right plugs aside.
2. Connect **RED** plugs to your HIGH BEAM headlight bulbs.
3. Connect **BLUE** plugs to your LOW BEAM headlight bulbs.
4. Mount the optic sensor (see details below).
5. Tap green wire onto wire that connects your horn button to the horn. (Optional)

### OPTIC SENSOR

The optic sensor needs to be mounted in a water protected area pointing downward toward the front fender. For permanent installation, you can drill a 5/16" hole and mount the sensor or you can use a zip tie to secure it to an existing wire bundle.



### NOTES

- 1.) As per DOT regulations, the Heads Up Alert feature DOES NOT work at night.
- 2.) The headlight module is designed for use on motorcycles with a 12 volt DC negative ground electrical system; and will not work on motorcycles with an AC electrical system.
- 3.) It can be used with any sealed beam or halogen headlight up to 130 watts for the low beam, and 130 watts for the high beam (260 watts total).
- 4.) Module is NOT compatible with HID or LED Lighting. If you have any questions regarding electrical system compatibility with your motorcycle, contact your motorcycle's manufacturer or authorized dealership.
- 5.) The Headlight Module has been designed to provide static free operation with your radio and intercom systems; however, some hard-wired systems will still produce unwanted static.
- 6.) The Plug & Play™ Headlight Module is legal on motorcycles in all 50 States & Canada.
- 7.) Test function once installed with incandescent lighting or pull bike outdoors, fluorescent and LED lighting will not activate module.
- 8.) If headlights are not working at all after installation, check the polarity of the plugs to your motorcycle harness, if the ground wires are not matched you may have blown a fuse. Correct the polarity issue, replace your fuse, and check your headlight function again.

**TECH SUPPORT | MON-FRI 9AM-5PM EST**  
(904) 342-4008 OR [INFO@SIGNALLDYNAMICS.COM](mailto:INFO@SIGNALLDYNAMICS.COM)